

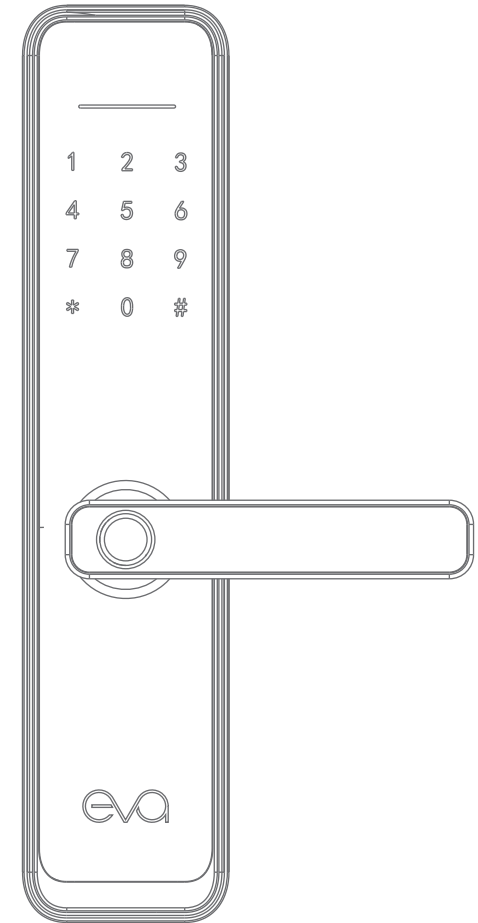

EVA | M5



USER MANUAL

## THINGS TO TAKE NOTE WHEN INSTALLING

Do not use strong force when installing, avoid damaging the lock.

Use correct installation tools.

Wear goggles to protect your eyes from injury when drilling holes.

Drill from both sides to avoid damaging the door surface.

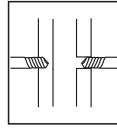
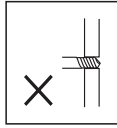
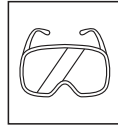
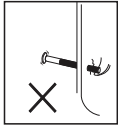

### NOTE:

- It is always advised to seek professional locksmith / lock installers to perform door lock installation.
- Please read this instruction manual before installation and operation of smart door lock.
- Pay attention to the wire connector direction and connect it correctly during installation.
- Follow the instructions given and adjust the door handle and latch accordingly to your door setup.
- It is very important to always keep the door open and carry the physical key along throughout the installation.
- Always check if the fingerprint reader, keypad, IC card, physical key, door handle, and manual bolt knob works normally after installation. Check for installation error if it doesn't work properly.

## 1 IDENTIFY DOOR HANDLE DIRECTION

- Identify the direction of your handle and switch your Eva M5 smart lock handle accordingly to your door handle direction.
- Follow the instructions below closely to switch handle direction.

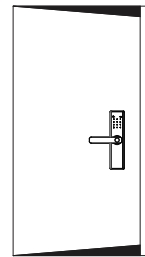

Left Handle

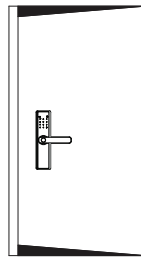

Right Handle

## 2 SWITCHING DOOR HANDLE DIRECTION

- Remove the Handle Lock Screw as shown on diagram, and rotate the handle to the opposite direction.
- Install the screw and tighten it to lock the handle into position after rotating the handle.

Make sure the arrow icon on the Square Rod Socket is pointing downwards to "Double" position.

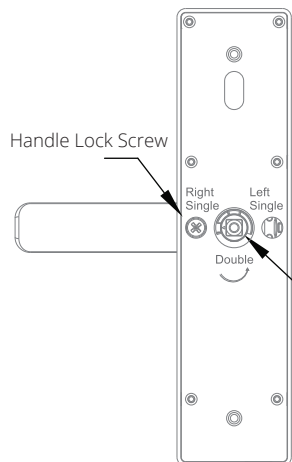

## 3 IDENTIFY DOOR OPENING DIRECTION

- After identifying door handle direction from previous step, identify your door opening direction whether it is inwards or outwards, then determine the Lock Latch direction from the diagram below.

### DOOR OPENING DIRECTION

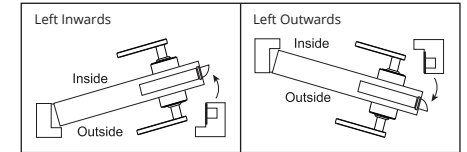
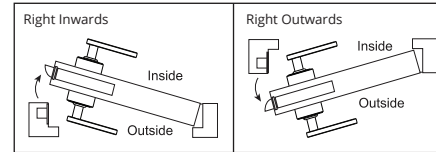

### LOCK LATCH DIRECTION ACCORDING TO DOOR OPENING DIRECTION

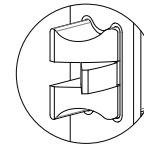

Right Inwards

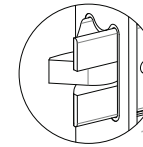

Right Outwards

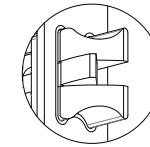

Left Inwards

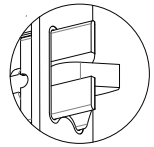

Left Outwards

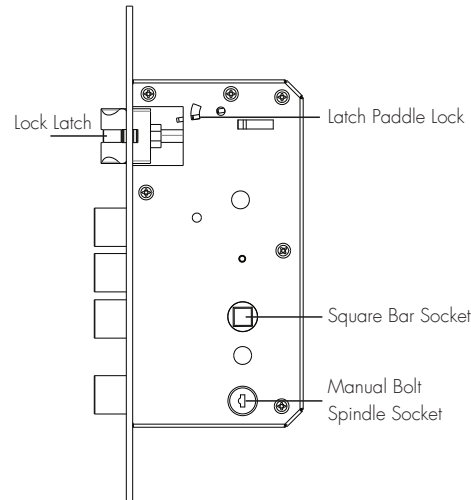

## 4 REVERSING DOOR LATCH

- Identify your door opening direction, and then identify your Lock Latch direction from the diagram above and adjust the Lock Latch accordingly.
- Push the Latch Paddle Lock upwards to allow the Latch to be pushed all the way in.
- Push the Latch into the lock body and rotate 180° to the opposite direction.
- Release the Latch Paddle Lock.

## 5 INSTALLING LOCK BODY

- Use the Drill Template provided to drill appropriate holes at the door for installation of lock body.
- Carve out bigger hole space or internal space inside the door accordingly if necessary to fit the lock body into the door.
- Make sure the drill openings on the the door align with the holes and sockets on the lock body.
- Screw the lock body into place.

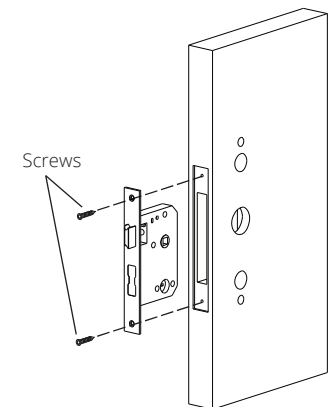

## 6 DOOR LOCK INSTALLATION

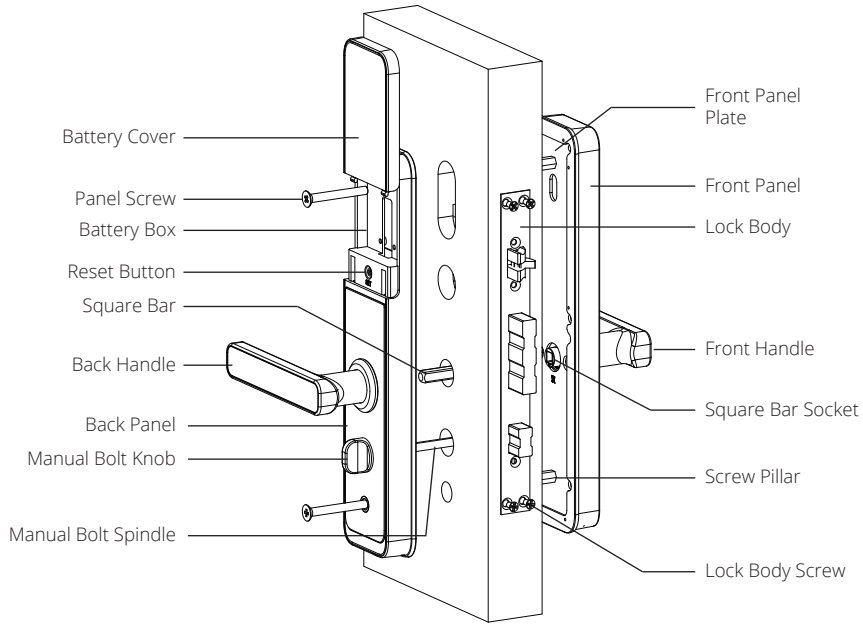

- Install the lock body first before installing the door panels.
- Connect Screw Pillars onto the top and bottom of Front Panel Plate.
- Insert the Square Bar into Front Panel Square Bar Socket.
- Pull the Front Plate Wire through the door hole opening.
- Align the Front Plate with the door hole openings, make sure there are holes for the Screw Pillars, Square Bar, and Wire to insert through the door.
- Connect the Front Panel Wire to the Back Panel Wire, make sure the wires are connected properly. And push the long wires into the door to hide it.
- Insert the Spindle through the door opening into the lock body Spindle Socket (Cut the length accordingly if needed).
- Align the Back Panel to the door openings, Square Bar, and Spindle. Push both panels against the door firmly and make sure both panels are aligned straight.
- Tighten the Panel Screws at the Back Panel to secure the lock into place.

## 7 INSTALLING THE STRIKE PLATE

- Remove the current strike plate from your door frame.
- Replace the old strike plate with the one included in the box.
- Install the strike plate accordingly as per diagram.
- Make sure the strike plate is installed correctly according to your door opening direction.

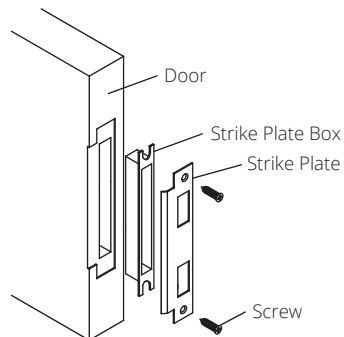

3

## EVA M5 SMART LOCK OPERATION MANUAL

### DESCRIPTION OF TERMS AND FUNCTION KEYS

- **Administrator information** :- refers to the registered administrator's fingerprint, password, or IC card.
- **Unlock information** :- refers to the input of registered fingerprint, password, or IC card (including administrator's)
- Only 9 admin information can be set. (Admin ID #001 - #009).
- Common user ID starts from #010.
- To check unlock information ID, unlock the door with fingerprint, password, or IC card. Then press "\*" to check ID number.

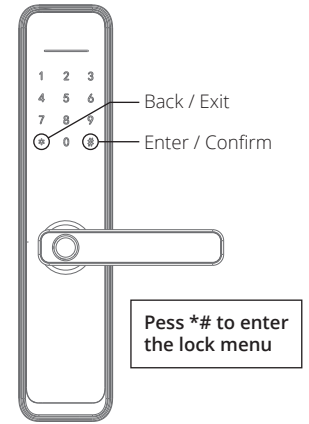

Press \*# to enter the lock menu

Factory Default Password "123456"

### FACTORY DEFAULT SETTINGS / ORIGINAL STATE / DEMO MODE

- In the original factory default settings / original state / demo mode, any fingerprint, password, or IC card can unlock.
- Factory default administrator password is "123456". Use this password to enter the administrator menu for the first time to set the administrator unlock information (fingerprint, password, IC card)
- Once the first admin information is set, only registered unlock information is able to unlock.

### LOCK MENU HIERARCHY

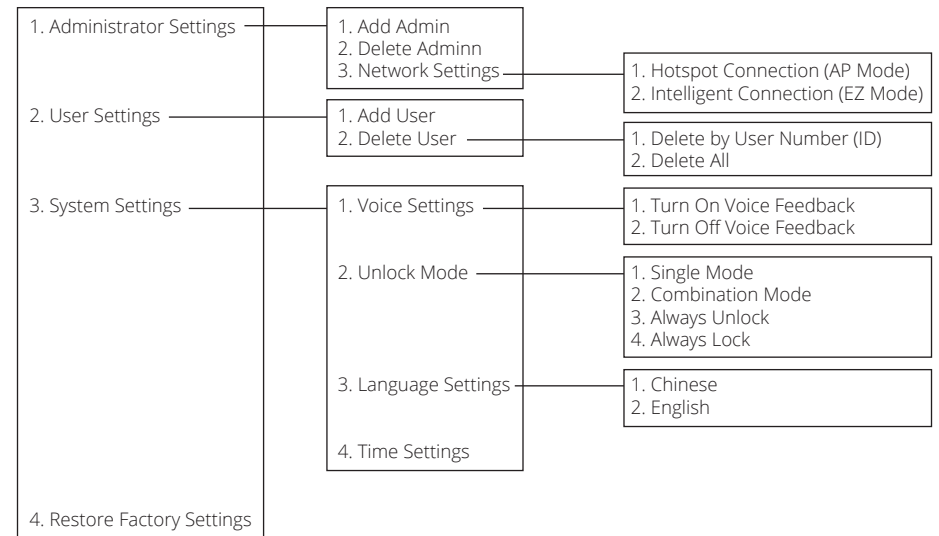

4

### FIRST TIME ADMIN REGISTRATION

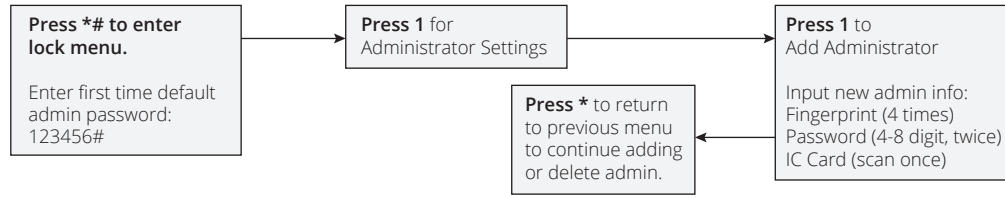

### ADD AND DELETE ADMIN INFORMATION

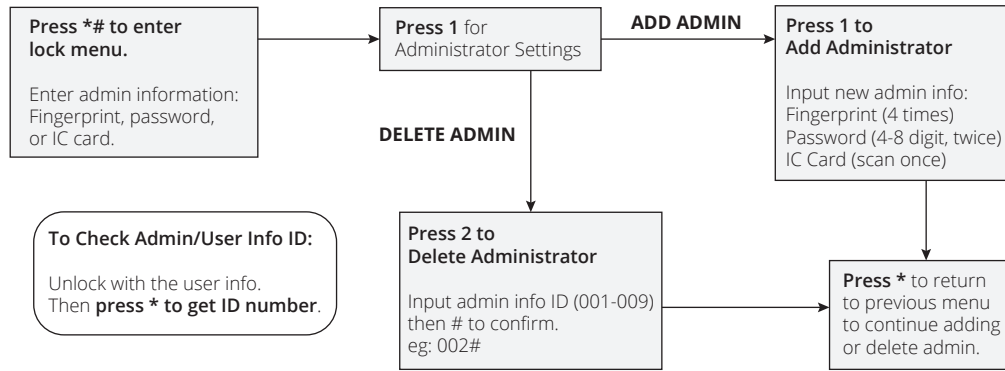

### ADD AND DELETE USER INFORMATION

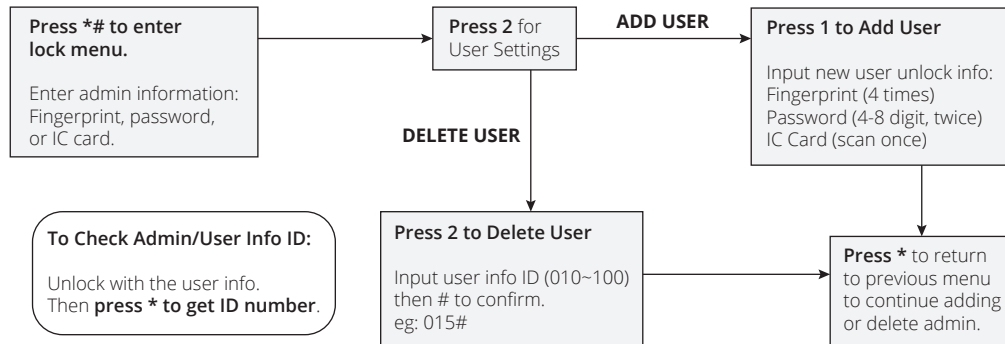

### SYSTEM SETTINGS

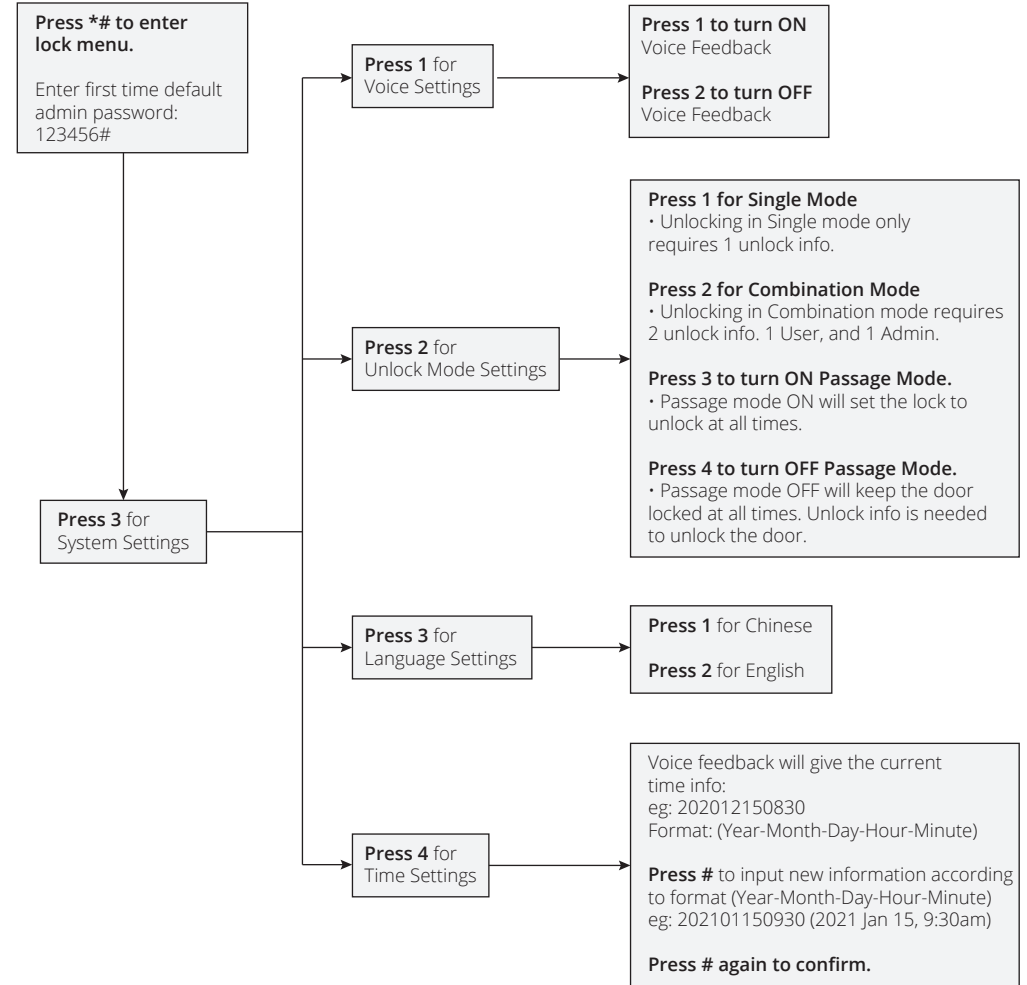

### RESTORE FACTORY SETTINGS

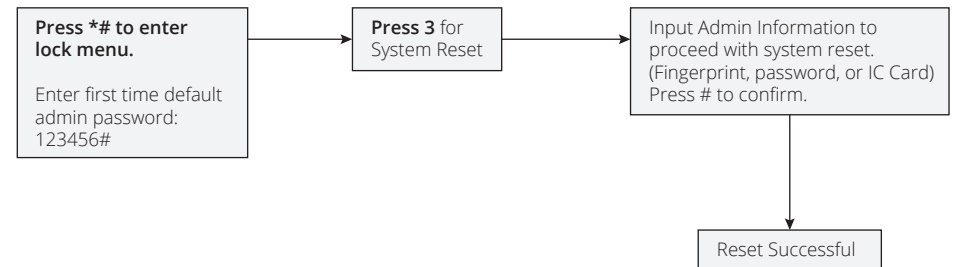

## DEVICE AND APP CONFIGURATION STEPS

### DOWNLOAD APP AND REGISTER ACCOUNT



Scan to Download App

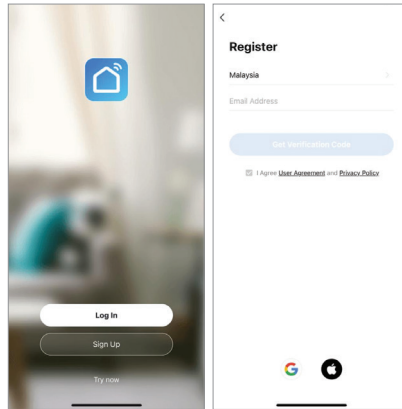

- Scan QR to download app on your device.
- For first time user, register an account.
- For current users, login to your account.

### ADD DEVICE INTO APP

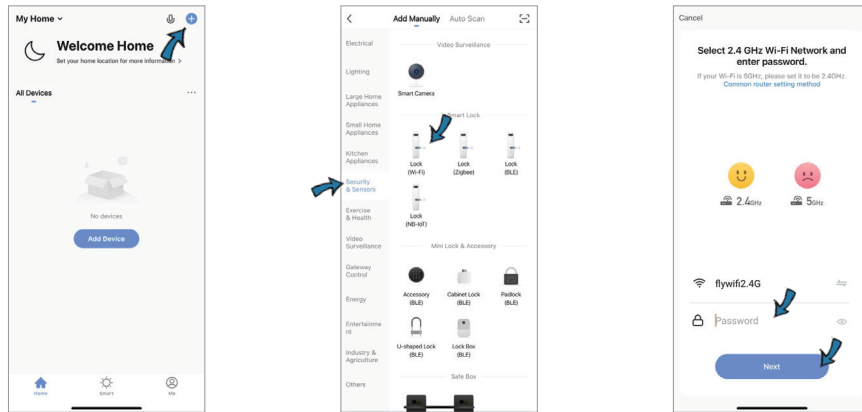

- At the Home Page, select the + icon to start adding your lock.
- Select "Security & Sensors".
- Then choose "Lock (Wi-Fi)".
- Enter the password for your 2.4GHz Wifi network. Do not copy & paste password.
- Then select "Next" to go to the next step.

#### NOTE:

- Make sure your smart device / phone is connected to 2.4GHz WiFi network, NOT 5GHz network.
- Key in your password, not copy & paste.

## PREPARE YOUR LOCK FOR ADDING

Prepare your lock for adding in order for the lock to be detected in the network.

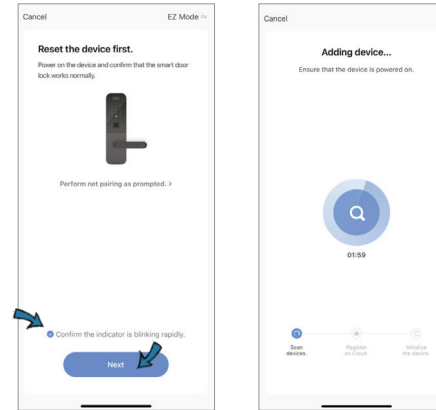
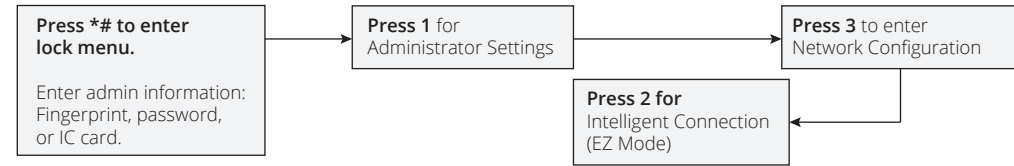

- On your app, check the "Confirm the indicator is blinking rapidly" checkbox, and select "Next" to search the lock.
- Once above steps have been done, 1, 2, 3, 4 keys will light up on the keypad to show adding progress and you will hear "operation completed" voice prompt.
- In the event of device add failure, you will hear "operation failed" upon time out.

#### NOTE:

- Make sure to do First Time Administrator Setup first before setting up the lock for network configuration.

## APP FUNCTIONS

### REMOTE UNLOCKING

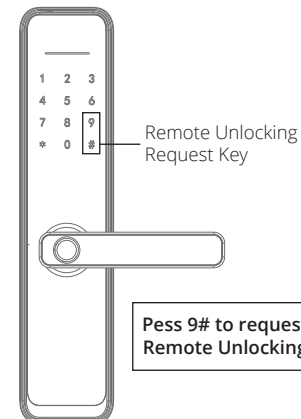

Press 9# to request Remote Unlocking

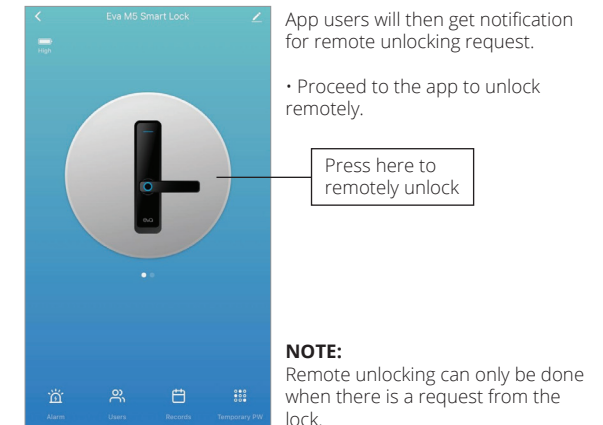

App users will then get notification for remote unlocking request.

- Proceed to the app to unlock remotely.

Press here to remotely unlock

#### NOTE:

- Remote unlocking can only be done when there is a request from the lock.

## DYNAMIC PASSWORD

Dynamic Password only valid for 5 minutes, and can be used to allow temporary access.

- To create dynamic password, swipe left from the device main page and press on the center button to generate a random password.

- Press on the button again to copy the password to the clipboard and paste it anywhere to share.

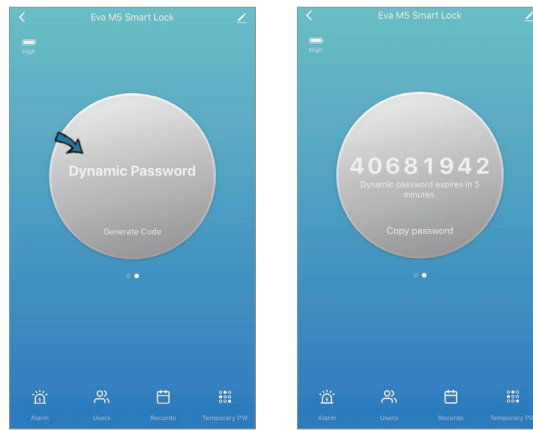

## TEMPORARY PASSWORD

The difference of Temporary Password and Dynamic Password is the validity period setting. The duration of Temporary Password can be set by the user to allow visitor access for a period of time.

- To create Temporary Password, select "Temporary PW" icon (lower right corner) from the device main page.

- Select the "+" icon on the upper right corner.

- Enter the password of your choice, or get a random password by selecting "Get Randomly".

- Enter the name of the password (recommended to use the password as name)

- Then set the starting time and ending time of the password.

- Once the password is created, it will only be valid from the start time until the end time.

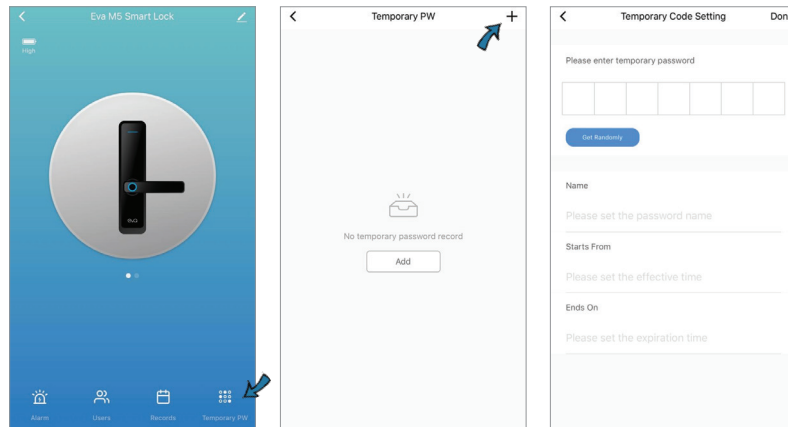

### NOTE:

- Newly created password can only be uploaded to the lock when the lock is awake.
- New password will be pending for upload until it is awake / keypad is touched.

## OTHER FUNCTIONS & NOTES

### PASSAGE MODE (ALWAYS-UNLOCKED MODE)

- When unlocking, press 5# to enable passage mode (always unlocked).
- To disable passage mode, key in any valid password/fingerprint.

### ANTI-PEEP FUNCTION

- When keying in password, enter any number before and after the real password to unlock. eg: 1234(12345678)1234



Scan for More In-Depth Tutorials

### KEYPAD FREEZE

- If password is input wrongly for 5 times in a row, the keypad will freeze for 30 seconds.

### LOW VOLTAGE ALARM

- When battery voltage dropped to 4.6V, low voltage alarm will be prompted everytime during unlocking.
- From the first prompt, the lock can be unlocked for about 200 times until the battery runs flat.

Technical Parameters			
	Items	Parameters	Memo
1	Static current	≤50uA	
2	Dynamic current	≤180mA	
3	Administrators number	9	
4	Fingerprint number	100	
5	Fingerprint + password + card capacity	300	
6	Fingerprint Sensor	Semiconductor	
7	Fingerprint contrast time	≤0.6Second	
8	Fingerprint identification Angle	360°	
9	False Rejection Rate	≤0.1%	
10	False Recognition Rate	≤0.0001%	
11	Reaction time	≤0.1 Second	
12	Power type	6V	
13	Emergency power	5VDC	
14	Working temperature	-25°C~60°C	
15	Working Relative Humidity	20%~90%RH	
16	Human voice	Yes	
17	Keyboard	Touch standard 12-bit keyboard	
18	Password Length	4-8 digits	
19	Phantom password	32 digits	
20	Low voltage alarm	4.6±0.2V	
21	Unlock time	≤1Second	