

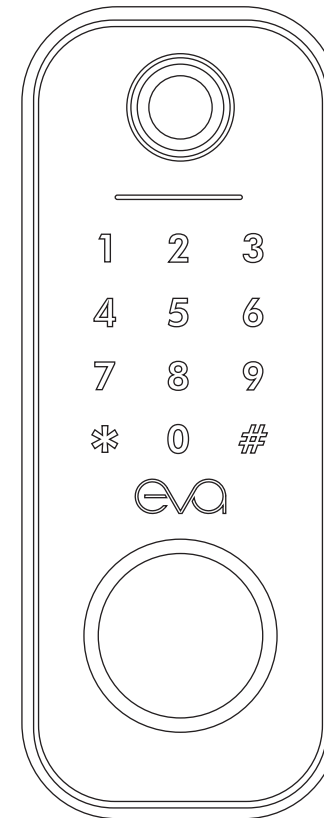

EVA | G1

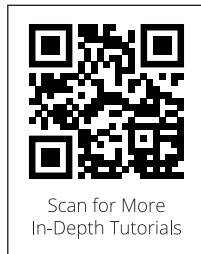

USER MANUAL

www.evasmart.co

updated 23.12.22

INSTALLATION MANUAL

THINGS TO TAKE NOTE WHEN INSTALLING

Do not use strong force when installing, avoid damaging the lock.

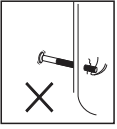

Use correct installation tools.



Wear goggles to protect your eyes from injury when drilling holes.



Drill from both sides to avoid damaging the door surface.

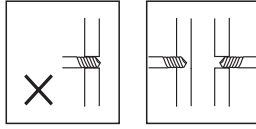

NOTE:

- It is always recommended to seek professional locksmith / installers to perform door lock installation.
- Please read this instruction manual before installation and operation of Eva G1 Smart Grill Lock.
- Pay attention to the wire connector direction and connect it correctly during installation.
- Follow the instructions given and adjust the back panel keypad accordingly to your door setup.
- It is very important to always keep the door open and carry the physical key along throughout the installation.
- Always check if the fingerprint reader, keypad, IC card, and physical key, works normally after installation. Check for installation error if it doesn't work properly.

PRODUCT DIMENSION AND INSTALLATION SPECIFICATION

Recommended installation plate size: W140 x H155mm

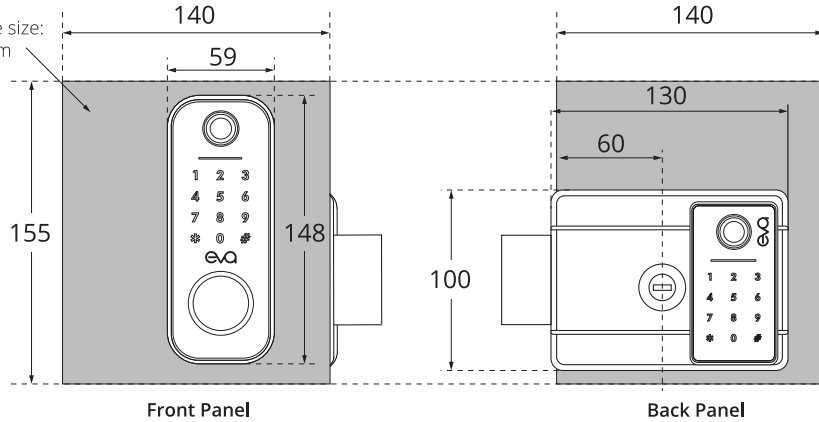

IDENTIFY DOOR OPENING SIDE

- Identify the side of your door opening and rotate the back panel keypad accordingly if needed.
- Follow the instructions on the next page to adjust back panel keypad module.

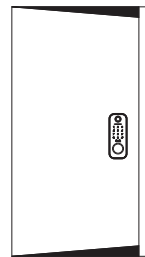

Left Open
(Door opens to the left)

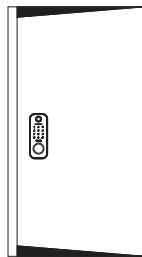

Right Open
(Door opens to the right)

ADJUST BACK PANEL KEYPAD MODULE

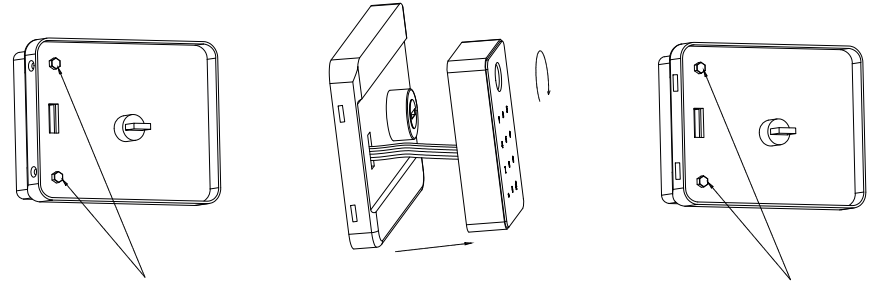

- 1** Remove both screw nuts from the back panel cover.
- 2** Remove to keypad module and rotate 180° (upside down)
- 3** Tighten back both screw nuts once again.

INSTALLATION OVERVIEW

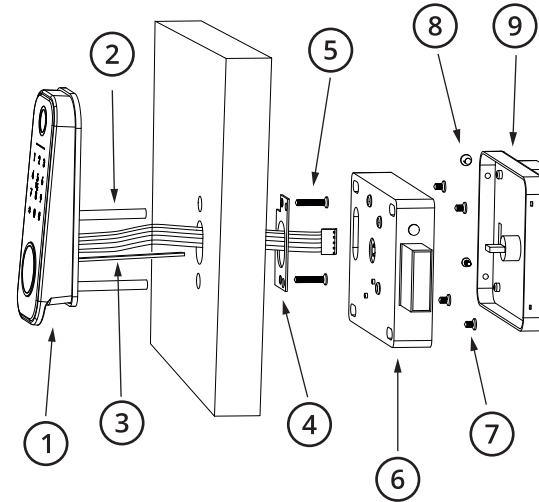

INSTALLATION PARTS LIST

- 1** Front Panel x1
- 2** Pillar Screws x2
- 3** Cylinder and Spindle x1
- 4** Backplate x1
- 5** Front Panel Mounting Screws x2
- 6** Back Panel Base x2
- 7** Back Panel Base Mounting Screws x4
- 8** Back Panel Cover Locking Screws x4
- 9** Back Panel Cover x1

LOCK INSTALLATION STEPS

1

Drill holes on the door / grill accordingly to the drill template provided..

2

Open the front key cover and insert the cylinder. Choose the suitable pillar screws and tighten onto the front panel

3

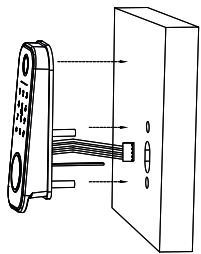

Insert the data cable, spindle, and pillar screws through the drill holes and hold the panel firmly against the door.

4

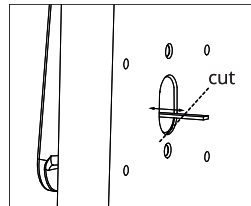

Measure the length of the required spindle part and cut accordingly to length. The end of spindle should not be sticking out from the back panel spindle slot.

5

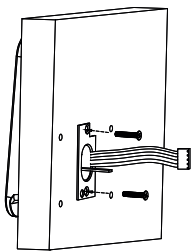

Insert the data cable and spindle through the backplate and tighten the front panel mounting screws.

6

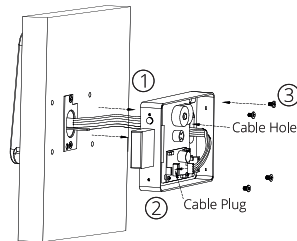

- ① Insert the data cable through the cable hole and insert the spindle into the spindle slot.
- ② Connect the cable connector to the cable plug.
- ③ Fix the back panel onto the door with screws.

7

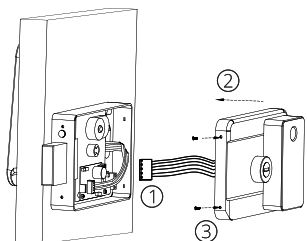

- ① Connect the back panel keypad module to the cable plug.
- ② Install the back cover onto the back panel.
- ③ Tighten the locking screws.

LOCK TESTING

- Please take note that the default factory state password is 123456.
- Key in 123456#, scan any fingerprint, scan any card, to test whether the lock can be unlocked.
- Then test if the physical key can be used to unlock.

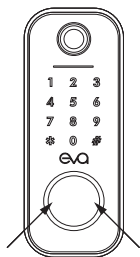

- ① Press the left or right side of the key hole cover to pop it up.
- ② Rotate the cover left or right to open up the cover.
- ③ Expose the keyhole and insert the physical key provided in the packaging to test if it can be used.

OPERATION MANUAL

DESCRIPTION OF TERMS AND FUNCTION KEYS

- **Administrator information:** refers to the registered administrator's fingerprint, password, or IC card.
- **Unlock information:** refers to the input of registered fingerprint, password, or IC card (including administrator's)
- Only 9 admin information can be set. (Admin ID #001 - #009).
- Common user ID starts from #010.
- Each unlock information is saved with an ID NUMBER #001 - #999
- Please remember the ID number for each password, ID number is required when deleting password.

NOTE:

Front keypad and rear keypad information is stored separately in each keypad. It is required to add password on BOTH front and rear keypad.

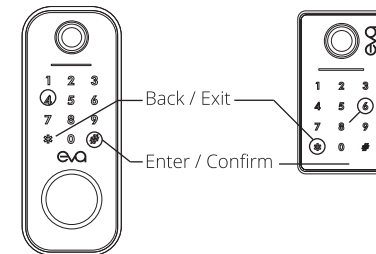

FACTORY DEFAULT SETTINGS / DEMO MODE

- In the original factory default settings / original state / demo mode, any fingerprint, password, or IC card can unlock.
- Factory default administrator password is "123456". Use this password to enter the administrator menu for the first time to set the administrator unlock information (fingerprint, password, IC card)
- Once the first admin information is set, only registered unlock information is able to unlock.

Press * # to enter the lock menu

Factory Default Password "123456"

LOCK MENU HIERARCHY

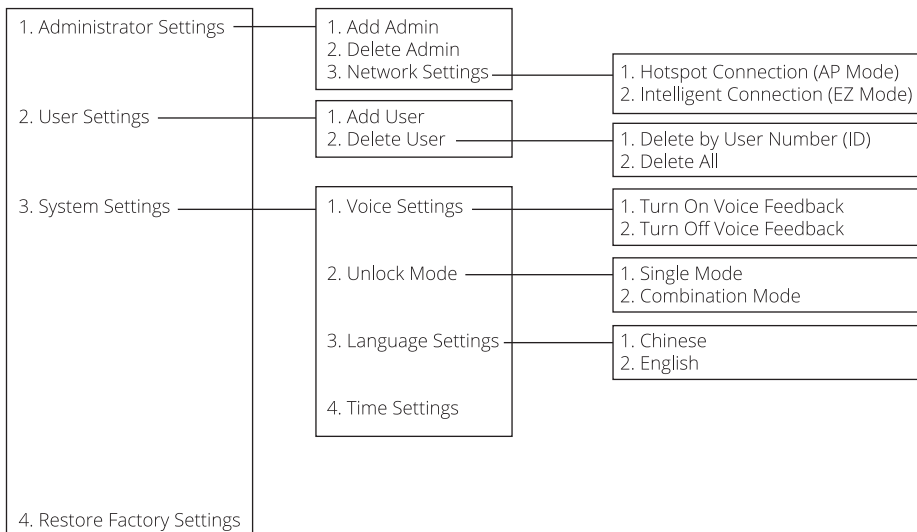

FIRST TIME ADMIN REGISTRATION

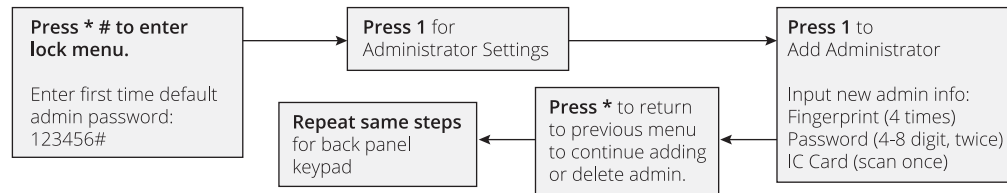

ADD AND DELETE ADMIN INFORMATION

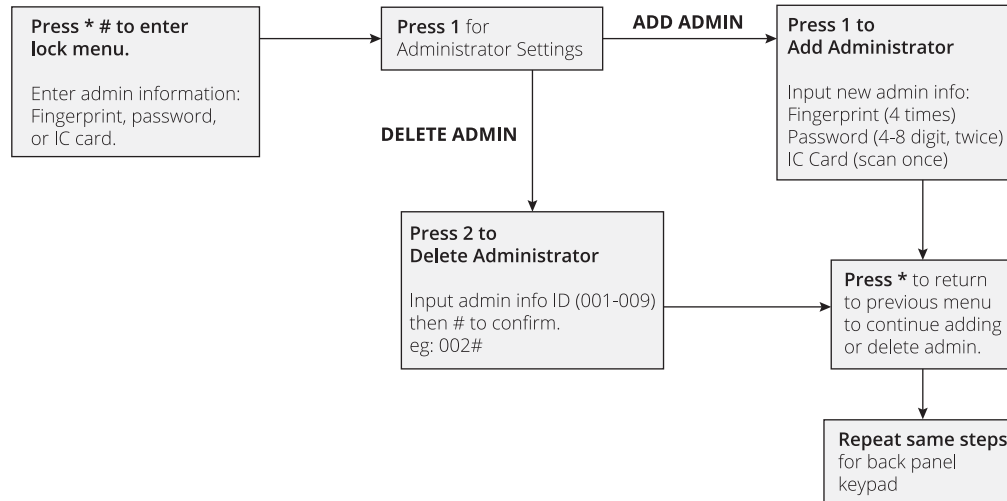

ADD AND DELETE USER INFORMATION

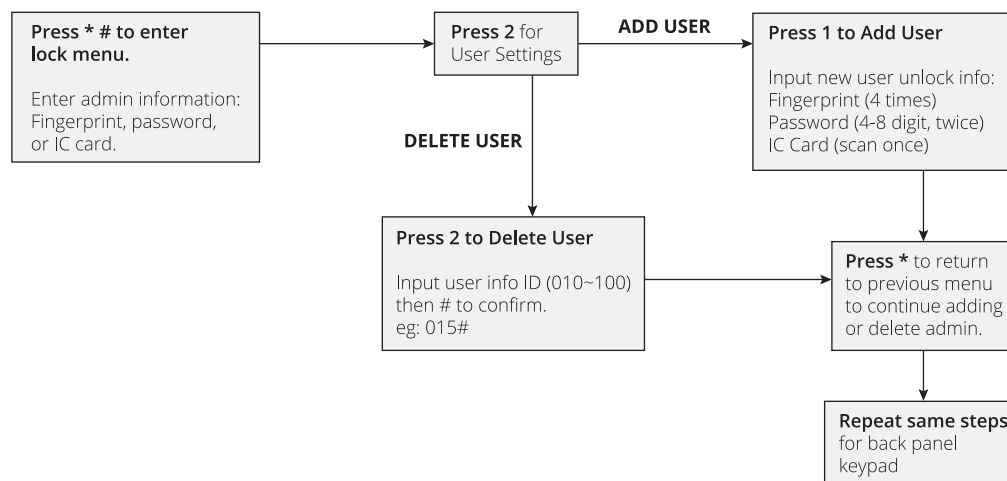

SYSTEM SETTINGS

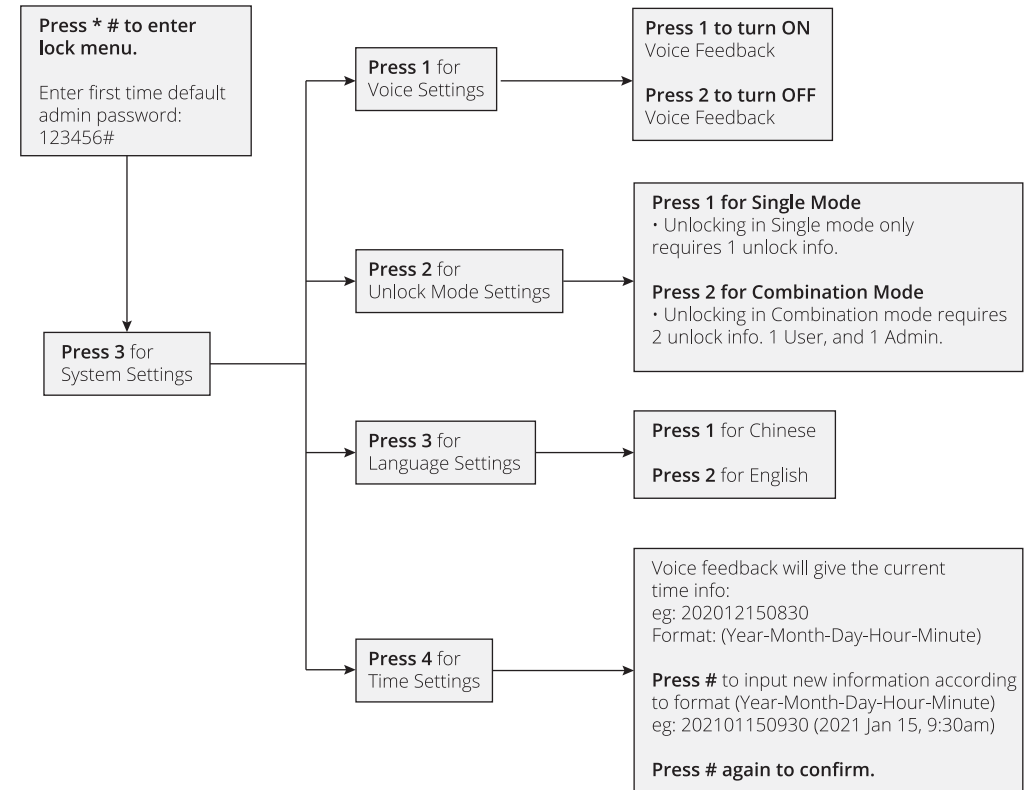

RESTORE FACTORY SETTINGS

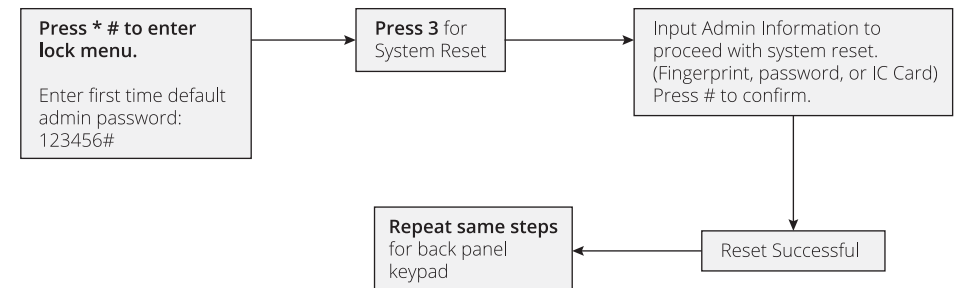

DEVICE AND APP CONFIGURATION STEPS

NOTE:

- Wi-Fi adding is only available for FRONT PANEL. Please perform all Wi-Fi adding steps from the FRONT PANEL only.
- Make sure to do First Time Administrator Setup first before setting up the lock for network configuration.

1 DOWNLOAD APP AND REGISTER ACCOUNT



Scan to Download App

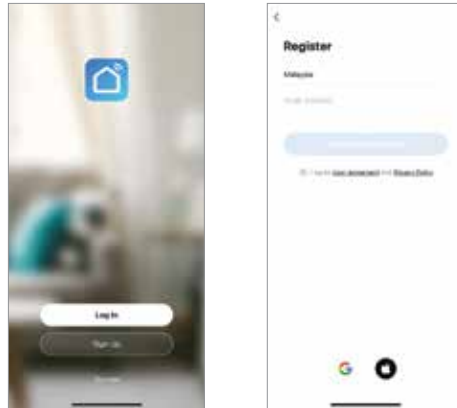

- Scan QR to download app on your device.
- For first time user, register an account.
- For current users, login to your account.

2 ADD DEVICE INTO APP

There are 3 ways to add Eva G1 into the app.

- 1) Intelligent Connection
 - A) Bluetooth Discovery
 - B) EZ Mode
- 2) Hotspot Connection / AP Mode

METHOD 1: BLUETOOTH DISCOVERY

Follow this instruction on the front panel keypad to set your lock into pairing mode.

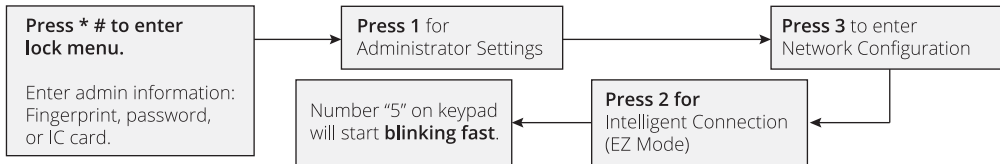

- 1) Turn on your phone's Bluetooth.
- 2) Connect your phone to 2.4GHz Wi-Fi network.
- 3) At the Home Page, select the + icon to start adding your lock.
- 4) App will auto search Eva G1 by Bluetooth Search, tap on "Add" once the lock is found.
- 5) Key in the correct 2.4GHz Wi-Fi password. DO NOT copy and paste the password.
- 6) Tap next to continue adding process.
- 7) Follow on-screen instructions to finish adding Eva G1.



METHOD 2: SELECT MANUALLY FROM LIST (EZ MODE)

Follow this instruction on the front panel keypad to set your lock into pairing mode.

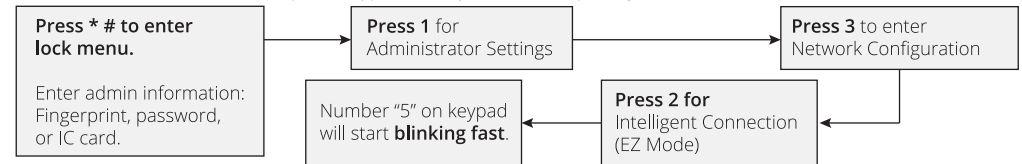

- 1) At the Add Device page, select "Camera & Lock" tab on the left, and choose "Lock (Wi-Fi)" from the list.
- 2) Tap next when asked to reset device.
- 3) Key in the correct 2.4GHz Wi-Fi password. DO NOT copy and paste the password.
- 4) Tap next to continue, and select "EZ Mode".
- 5) Follow on-screen instructions to finish adding Eva G1.

NOTE:

- Once above steps have been done, 1, 2, 3 keys will light up on the keypad to show adding progress and you will hear "successful" voice prompt.
- In the event of device add failure, you will hear voice prompt "failed" upon time out.

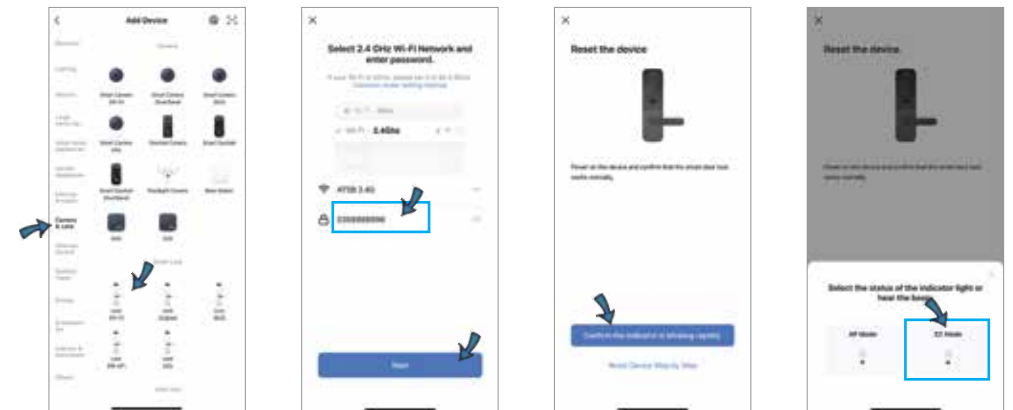

METHOD 3: HOTSPOT CONNECTION (AP MODE)

Follow this instruction on the front panel keypad to set your lock into pairing mode.

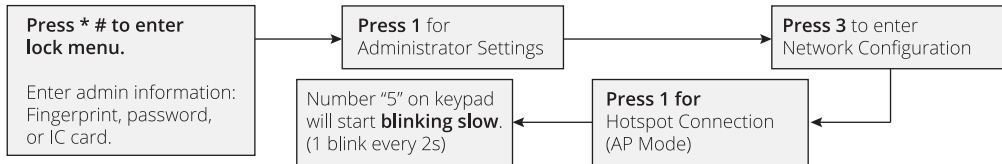

- 1) At the Add Device page, select "Camera & Lock" tab on the left, and choose "Lock (Wi-Fi)" from the list.
- 2) Tap next when asked to reset device.
- 3) Key in the correct 2.4GHz Wi-Fi password. DO NOT copy and paste the password.
- 4) Tap next to continue, and select "AP Mode".
- 5) Go to your phone's Wi-Fi settings and connect to the lock's AP "SmartLife-XXXX", then go back to the app to continue.

NOTE:

- Once above steps have been done, 1, 2, 3 keys will light up on the keypad to show adding progress and you will hear "successful" voice prompt.
- In the event of device add failure, you will hear voice prompt "failed" upon time out.

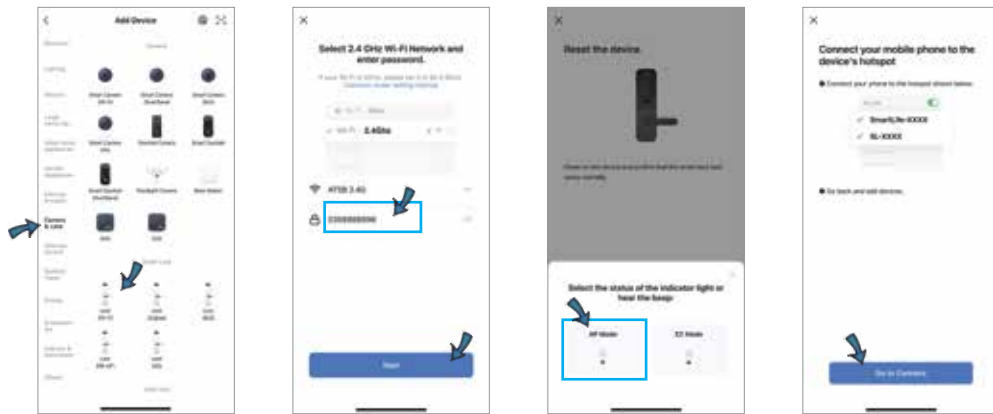

APP FUNCTIONS REMOTE UNLOCKING

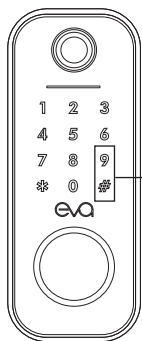

Front Panel

Remote Unlocking
Request Key

Press 9# to request
Remote Unlocking



App users will then get notification for remote unlocking request.

- Proceed to the app to unlock remotely.

Press here to
remotely unlock

NOTE:

- Remote unlocking function only available from the front panel keypad.
- Remote unlocking can only be done when there is a request from the lock.

DYNAMIC PASSWORD

Dynamic Password only valid for 5 minutes, and can be used to allow temporary access.

- To create dynamic password, swipe left from the device main page and press on the center button to generate a random password.

- Press on the button again to copy the password to the clipboard and paste it anywhere to share.



TEMPORARY PASSWORD

The difference between Temporary Password and Dynamic Password is the validity period setting.

The duration of Temporary Password can be set by the user to allow visitor access for a period of time.

- 1) To create Temporary Password, select "Temporary PW" icon (lower right corner) from the device main page.
- 2) Select the "+" icon on the upper right corner.
- 3) Enter the password of your choice, or get a random password by selecting "Get Randomly".
- 4) Enter the name of the password (recommended to use the password as name)
- 5) Then set the starting time and ending time of the password.
- 6) Once the password is created, it will only be valid from the start time until the end time.

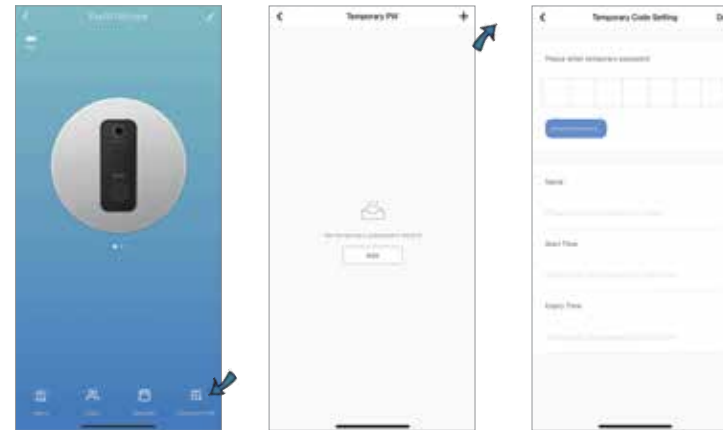

NOTE:

- Newly created password can only be uploaded to the lock when the lock is awake.
- New password will be pending for upload until it is awake / keypad is touched.

OTHER FUNCTIONS & NOTES

ANTI-PEEP FUNCTION

When keying in password, enter any number before and after the real password to unlock.
eg: 1234 (12345678) 1234

KEYPAD FREEZE

If password is input wrongly for 5 times in a row, the keypad will freeze for 30 seconds.

LOW VOLTAGE ALARM

- When battery voltage dropped to 4.6V, low voltage alarm will be prompted everytime during unlocking.
- From the first prompt, the lock can be unlocked for about 200 times until the battery runs flat.