



2-Channel Smart Autogate Controller



Quick Start Guide

GETTING STARTED

1. Make sure that your smart phone is connected to 2.4Ghz WiFi network at all times when performing add device.
2. Have your 2.4Ghz WiFi network password with you.
3. Smart phone is running on Android 4.0 / iOS 8.0 or higher.
4. Your router authentication is set to WEP / WPA / WPA2 and MAC filtering is disabled.

DOWNLOAD APP

Scan QR code below to download app



Android 4.0 / iOS 8.0 and above

WIRING DIAGRAM

Generic Autogate Board

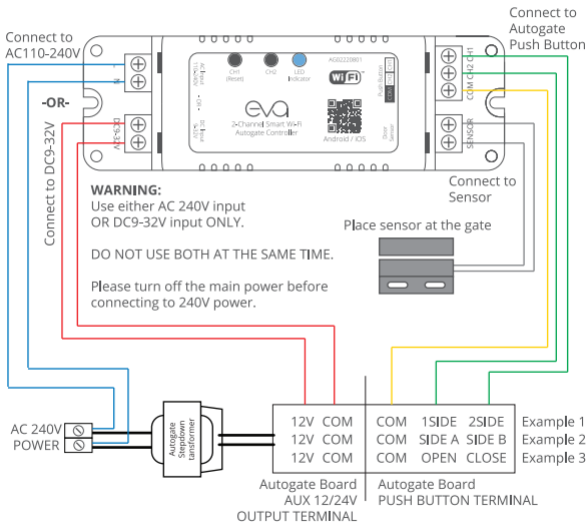

WIRING DIAGRAM

DC Moto / Digicraft Board

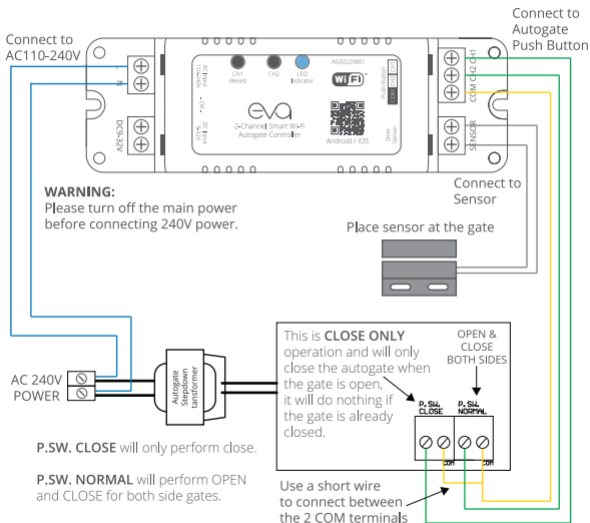

ACCOUNT REGISTRATION / LOGIN

1. For first time user, create an account and follow on-screen instructions to get verification code to complete your new account registration.

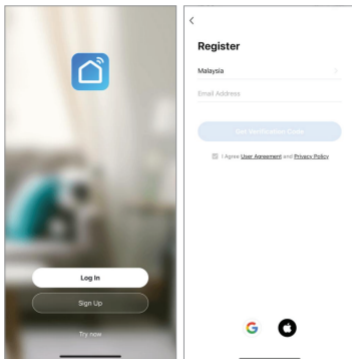

CONNECT POWER

1. Connect Eva Autogate Controller according to the diagram shown on page 2 & page 3.
2. Please choose only **ONE** power input, do not connect both AC input and DC input to the controller.

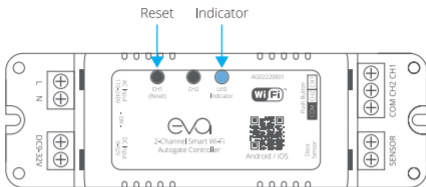

ADD DEVICE

There are 2 modes of adding Eva Autogate Controller into the app.

- Blink Quickly / EZ Mode (Default / Commonly used)
- Blink Slowly / AP Mode

EZ MODE (FAST BLINK / DEFAULT)

1. Once power is connected, the blue indicator light should be blinking fast (twice per second). If it's blinking slowly (once every 3 seconds) or not blinking, then press and hold on the reset button for 6 seconds to switch to EZ Mode (fast blink).
2. On the app, tap on the "+" icon at the top right corner of the app.
3. Choose device type "Electrical - Switch (Wi-Fi)"
4. Make sure your phone is connected to 2.4GHz WiFi network.
5. Follow on screen instructions. Key in your WiFi password when prompted. **DO NOT copy and paste your password.**

6. Tap on "Blink Quickly" when prompted.

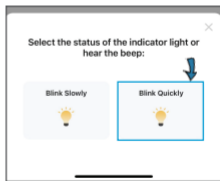

7. Once Eva Autogate Controller has successfully been setup, it will be added into the device list and the indicator light will turn solid.

AP MODE (SLOW BLINK)

AP mode setup is recommended for Mesh WiFi home network, or WiFi network that uses the same SSID for both 2.4GHz and 5GHz network.

1. Confirm if blue light is blinking slow (once every 2s). If it's blinking fast (2 flash / sec) or not blinking, then press and hold on the reset button for 6 seconds, repeat this step until indicator light is blinking slowly.
2. On the app, tap on the "+" icon at the top right corner of the app.
3. Choose device type "Electrical - Switch (Wi-Fi)"
4. Make sure your phone is connected to 2.4GHz WiFi network.
5. Follow on screen instructions. Key in your WiFi password when prompted. **DO NOT copy and paste your password.**
6. Select "Blink Slowly" when selection shows up.
7. Then connect your phone to the controller AP "SmartLife-XXXX" and then go back into the app to continue the adding process.
8. Once Eva Autogate Controller has successfully been setup, it will be added into the device list and the indicator light will turn solid.

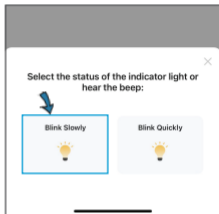

BASIC INTERFACE OPERATION

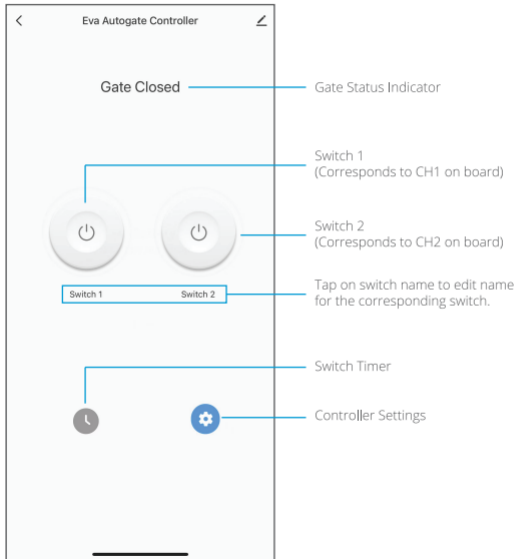

CONTROLLER SETTINGS

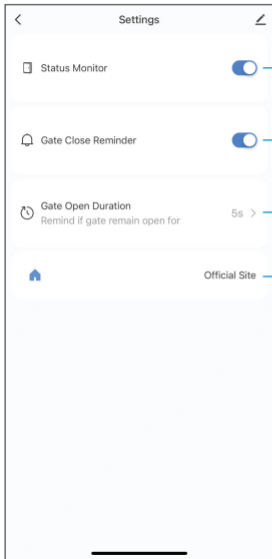

Turn on / off status indicator

Turn on / off reminder

Reminder after gate remain open for the set duration.
(Can only be changed when Gate Close Reminder is enabled)

Official Site Eva brand official website

CONNECTING TO 3RD PARTY VOICE ASSISTANT

1. From the Eva Autogate Controller main interface, select the  (pencil) icon to open up the “device information panel”.
2. At “Third-party Control” section, select the desired voice control assistant to connect.
3. assistant to connect.
4. Follow on screen instructions to proceed with account linking.

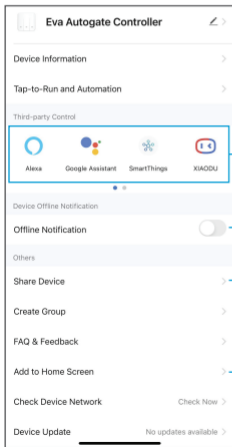

Link to 3rd party voice services.

Enable to get notification if controller goes offline for more than 30 minutes.

Share this device to other users.

Add controller interface shortcut to your device's home screen.

VOICE ASSISTANT SETTING & EXPLANATION

The default command that exist in the voice service platform is “Turn on / off, (Switch Name)”.

This controller acts as a momentary (push button) switch. Everytime after it is turned on, it will automatically turn off after 1 second. Therefore, only the “Turn on” command will open and close the gate, because the button by default is always off.

In order to use a custom phrase such as “Open / close the gate”, we have to create a “routine” on the voice platform app.

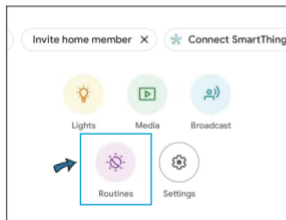

GOOGLE HOME APP

From the main page, you will find the “Routines” icon at the top, tap on it and create your own routine custom phrase.

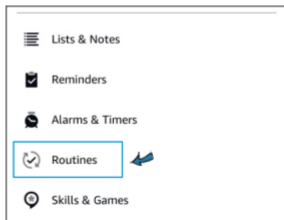

ALEXA APP

You will find the “Routines” selection after tapping on “More” at the bottom right of Alexa main page.

DEVICE SHARING

1. From the Eva Autogate Controller main interface, select the  (pencil) icon to open up the “device information panel”.
2. Select “Share Device” from the selection.
3. Select “Add Sharing” button at the bottom.
4. Follow on screen instructions to proceed to add member.

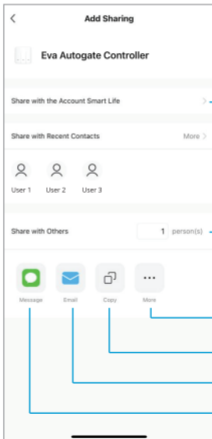
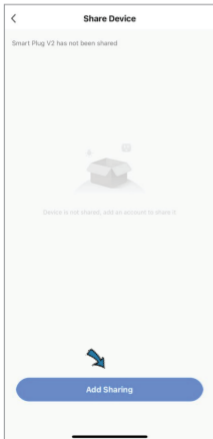

Share to app account users.

Create invite link for a number of users.

Share link via other app.

Copy invite link.

Email invite link.

Send invite link via SMS.

HOME SHARING

1. From the app main panel, select “Me” on the bottom right. Then select “Home Management” from the selection.
2. Choose a home that you would like to share.
3. NOTE: Home must be set up first.
4. Select “Add Member”, and choose your desired sharing method.

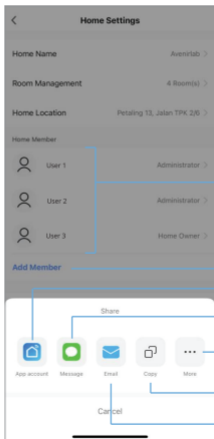
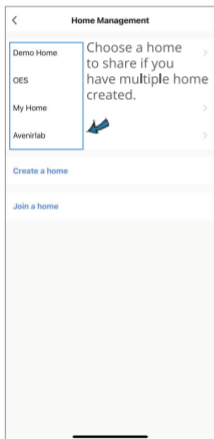

Current added members.

Add member.

Invite app account user.

Share invite link via SMS.

Share link via other app.

Copy invite link.

Share invite link via email.

HOME AUTOMATION FUNCTION

Eva Smart Autogate Controller can be automated alongside with other smart devices that bears the marking “Powered by Tuya” / devices that works with “Smart Life” or “Tuya Smart” app.

- Devices are required to be added into the same app to work.



Powered by Tuya label



Tuya Smart app



Smart Life app

There are mainly 2 types of automation:

1. Tap-to-Run

- Used for creating a “scene” or a shortcut button.
- A series of continuous action with the tap of a button.
- Can be used to execute actions from different devices.

2. Automation (Smart)

- Actions that run automatically when a pre-defined condition is met.
- Such as:
 - Timer / Schedule
 - Location changes
 - Device status changes
 - Weather changes

TAP-TO-RUN AUTOMATION

1. At the app main panel, select "Smart" at the bottom of the panel.
2. Select the  icon on the upper right corner to add new automation.
3. Select "Launch Tap-to-Run" to setup the automation.

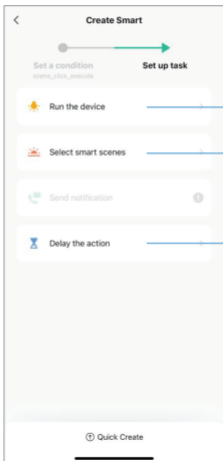
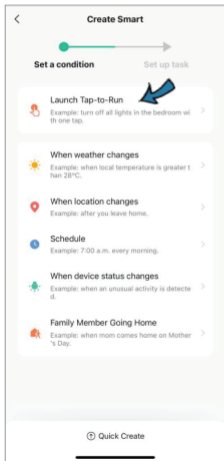

Control / make changes to the device.

Enable / disable a smart automation.

Set delay duration before next task.

AUTOMATION (SMART)

1. At the app main panel, select "Smart" at the bottom of the panel.
2. Select the  icon on the upper right corner to add new automation.
3. Select any smart automation task method to setup the automation.
4. Follow on-screen instructions to continue the setup.

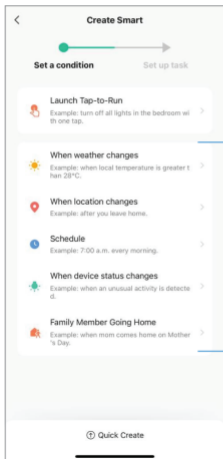

Smart automation tasks.

FAQ AND TROUBLESHOOTING

1. What kind of autogate is compatible?

- Any type of autogate, any frequency, any brand, and any model.

2. It keeps showing offline, what should I do?

- Make sure your home WiFi network is stable.
- Make sure signal strength is moderate / strong / stable at the location where the controller is installed.

3. What should I do when adding device process has failed?

- Check if power cable is connected properly.
- Check if your smart phone is connected to 2.4GHz WiFi network.
- Make sure your WiFi password entered in the app during adding device procedure is correct.
- Key in your WiFi password instead of copy and paste.
- Make sure the controller is in ready state for app configuration.
 - Blue indicator fast blink (twice per second) - EZ Mode
 - Blue indicator slow blink (once every 3 seconds) - AP ModeIf not, hold the button for 3 seconds until indicator starts blinking.
- Check your internet connection, make sure router and internet is working properly.
- If you're using Mesh WiFi, we recommend you adding using AP Mode (Slow Blink)
- Make sure router's broadcasting mode is enabled.

- Make sure router's encryption mode is set to WPA2-PSK and authorization mode is AES, or set both to Auto.
- Check if WiFi signal is strong enough at the Eva Smart Autogate Controller location. If weak, you may need to add a WiFi extender to extend your WiFi network to cover your autogate area.
- Check whether your router has reached maximum number of devices (usually max 30 devices). Disconnect some device WiFi connection and try again.
- Check if router's wireless MAC filtering function is enabled. Remove the device from filter list and make sure the router is not prohibiting Eva Smart Plug from connecting.

4. Can I open my autogate using my mobile 3G/4G network?

- After first time setup / added into app, you can remotely access and control your autogate using 3G/4G mobile network from your phone.



Demo videos



In-depth tutorials



For more info, please visit:
www.evasmart.co